

Instructions



Rackmount Installation Kit for the DSA8200, CSA8200, CSA8000, CSA8000B, TDS8200, TDS8000, and TDS8000B

071-0696-02

Warning

The servicing instructions are for use by qualified personnel only. To avoid personal injury, do not perform any servicing unless you are qualified to do so. Refer to all safety summaries prior to performing service.



071069602

Copyright © Tektronix. All rights reserved. Licensed software products are owned by Tektronix or its subsidiaries or suppliers, and are protected by national copyright laws and international treaty provisions.

Tektronix products are covered by U.S. and foreign patents, issued and pending. Information in this publication supercedes that in all previously published material. Specifications and price change privileges reserved.

TEKTRONIX and TEK are registered trademarks of Tektronix, Inc.

Contacting Tektronix

Tektronix, Inc.
14200 SW Karl Braun Drive
P.O. Box 500
Beaverton, OR 97077
USA

For product information, sales, service, and technical support:

- In North America, call 1-800-833-9200.
- Worldwide, visit www.tektronix.com to find contacts in your area.

Service Safety Summary

Only qualified personnel should perform service procedures. Read this *Service Safety Summary* and the *General Safety Summary* in the product service manual or the instruction manual.

Do Not Service Alone. Do not perform internal service or adjustments of this product unless another person capable of rendering first aid and resuscitation is present.

To prevent the instrument and rack from falling onto the operator, two or more installers should install the instrument into the rack cabinet. After completing the installation procedure, the installers should verify that the instrument and rack cabinet will not tip forward while the instrument is in the extended position.

Disconnect Power. To avoid electric shock, switch off the instrument power, then disconnect the power cord from the mains power.

Use Care When Servicing With Power On. Dangerous voltages or currents may exist in this product. Disconnect power, remove battery (if applicable), and disconnect test leads before removing protective panels, soldering, or replacing components.

To avoid electric shock, do not touch exposed connections.

Kit Description

This document describes how to install option 1R (rackmount kit) on your standard benchtop instrument. This kit enables you to mount any of the following mainframes into a standard 19-inch equipment rack.

Products

DSA8200

CSA8200, CSA8000, CSA8000B

TDS8200, TDS8000, TDS8000B

Kit Parts List

This table contains a list of the parts shown in Figure 1 on page 2.

Figure 1 callout number	Quantity	Part number	Description
-----	1 ea	016-1791-xx	This Rackmount Kit with Instruction manual and the following parts
1	1 ea	441-2231-00	Rackmount panel set consisting of: left and right side; and lower cover trim
2	1 ea	351-0313-01	Guide rack, consisting of: left and right side
3	4 ea	NS	Screw, mach: 10-32, panhead, 0.5 in l, phillips
3	7 ea	NS	Nut, locking washer: 10-32 assem
3	14 ea	NS	Screw, mach: 10-32, Truss-head, 0.5 in l, phillips
3	4 ea	NS	Screw, mach: M6 x 20 oval head, phillips
3	4 ea	NS	Screw, mach: M5 x 20 oval head, phillips
3	4 ea	NS	Screw, mach: 10-32 x 0.75 oval head, phillips
3	4 ea	NS	Screw, mach: 12-32 x 0.75 oval head, phillips
3	5 ea	NS	Washer: flat, nylon
4	1 ea	351-0241-01	Slide, drawer, extenders: Sliders
4	1 ea	NS	Rack: Mounting screws, nut blocks
5	2 ea	386-7279-00	Plate: ABS, bracket spacer
6	2 ea	367-0525-00	Handle: bracket, al, gray

NS - Not Saleable



CAUTION. To prevent static discharge damage, service the product only in a static-free environment. Observe standard handling precautions for static-sensitive devices while installing this kit. Always wear a grounded wrist strap, grounded foot strap, and static-resistant apparel while installing this kit.

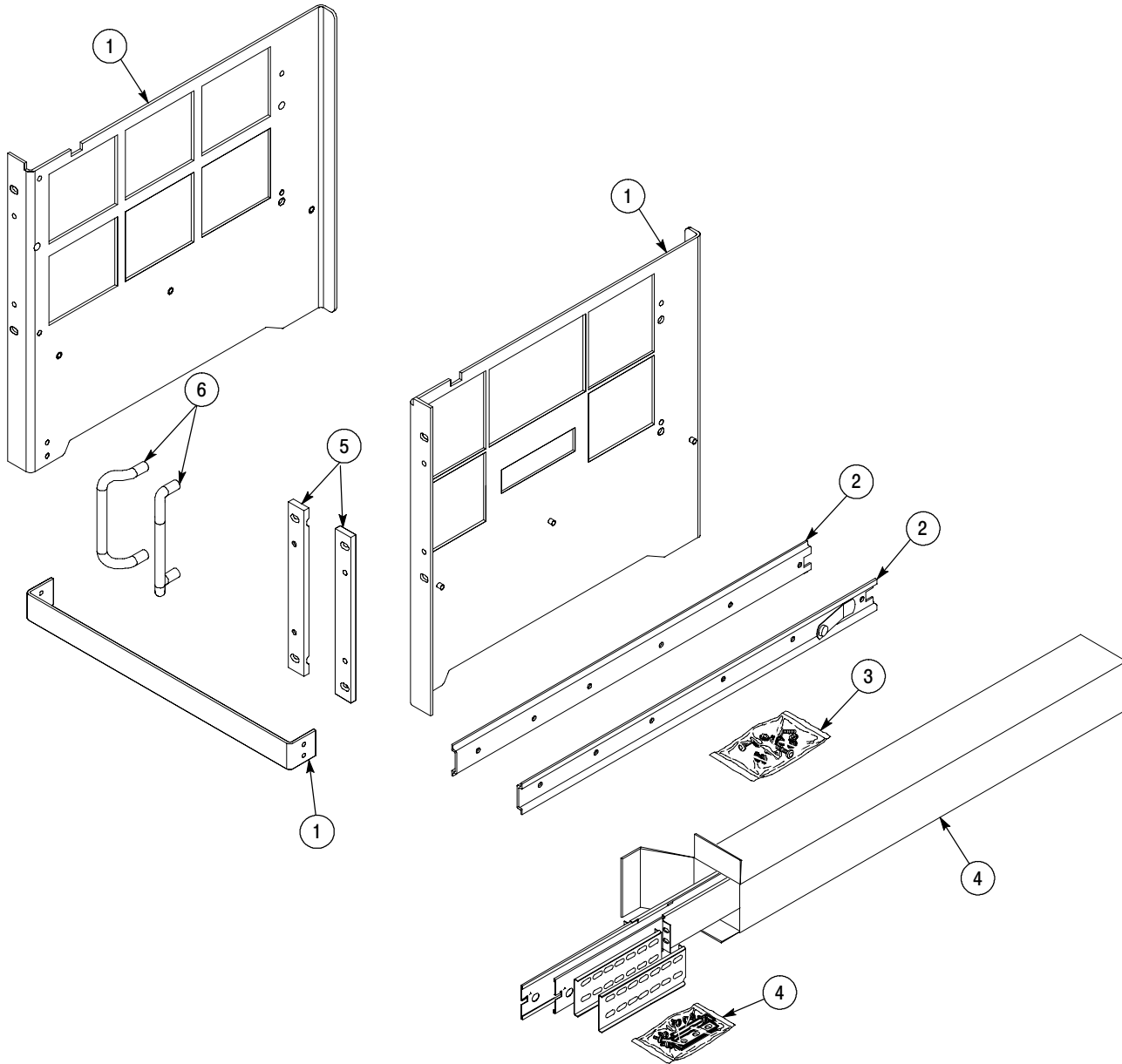

Figure 1: Rackmount kit parts

Specification Requirements

When the rackmount is installed according to the instructions in this document, the rackmounted instrument meets all warranted requirements listed in the Specification section of your instrument user or service manual except for those listed in Table 1 of this document. Instruments mounted using methods other than those described in these instructions may cause the instrument to not meet its warranted specifications.

Table 1: Warranted specifications

Characteristic	Description
Temperature, Inside Rack Cabinet	
Operating	+10 °C to +40 °C
Non-operating	-22 °C to +60 °C
Vibration	
Operating	0.24 g rms, from 5 to 500 Hz, 10 minutes each axis
Non-operating	2.22 g rms, from 5 to 500 Hz, 10 minutes each axis
Shock	
Operating and Non-operating	20 g, 11 ms, half sine, each axis, 3 drops each

NOTE. Refer to the sampling module User manual for individual module operating temperature range specifications.

Clearance Requirements

The following clearance requirements provide the rack-adapted instrument adequate space for air circulation and power cord clearance. The equipment rack in which you mount the instrument must provide these clearances. See Figure 2 on page 4.

- A minimum of fourteen inches (355 mm) of vertical space
- A minimum width of 17 5/8 inches (448 mm) between the left- and right-front rails in the rack
- A minimum inside depth of at least 20 inches (508 mm)



CAUTION. Adhering to these clearance requirements mounts the rack-adapted instrument with sufficient clearance for air circulation and accommodation of the power cord and mounting hardware. Failure to provide these clearances can result in overheating and/or instrument failure.

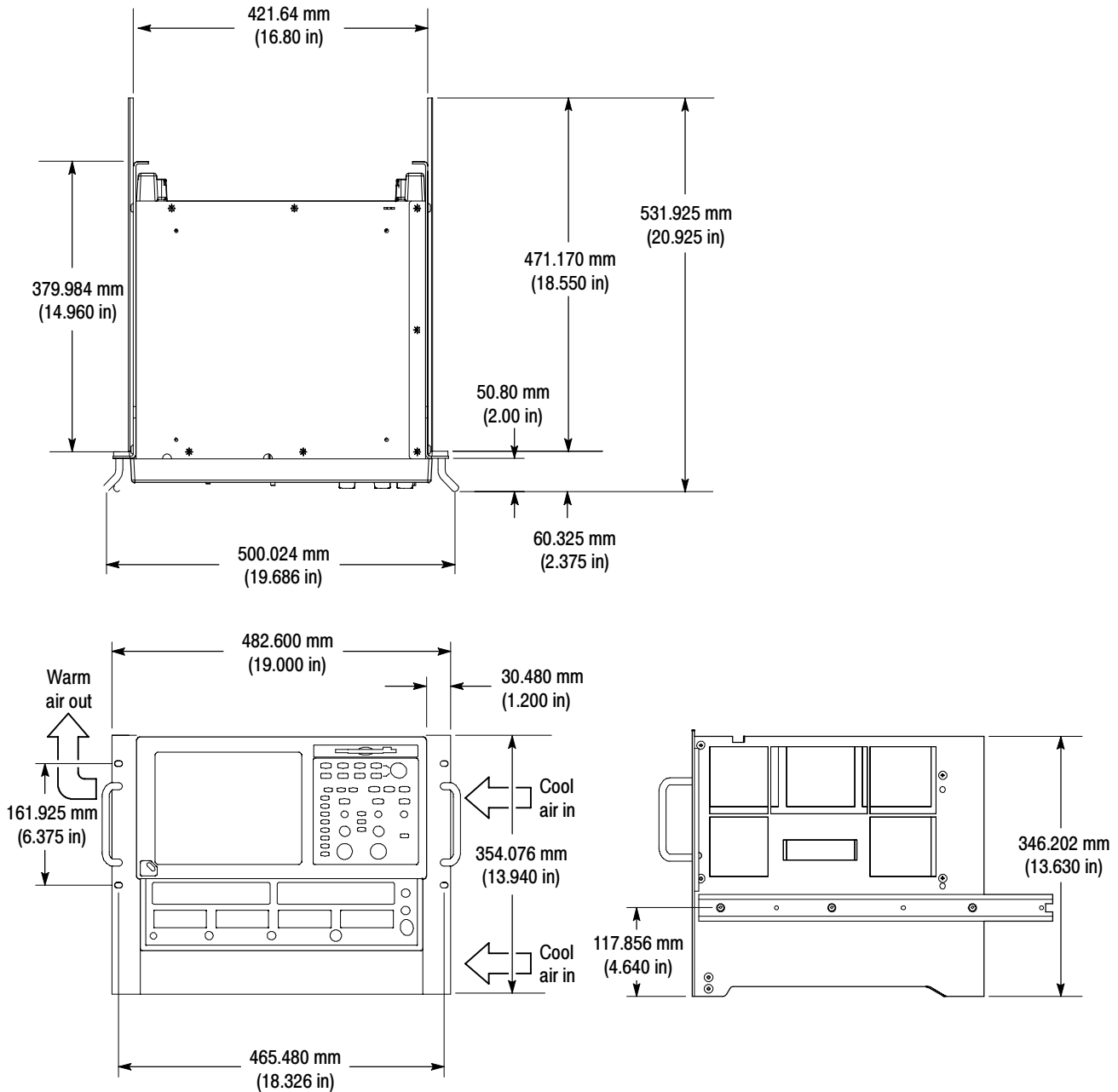

Figure 2: Instrument with rack adapter installed

Installation Instructions

This section contains all procedures needed to install a rack mount on your instrument and then install the instrument into a rack. There are three sections to the installation process:

- **Rackmount Panel Preassembly:** assembling the rack panels before attaching to your mainframe
- **Instrument Conversion:** removing the side, top, and bottom panels from your mainframe and attaching the assembled rack mount panels
- **Rackmounting the Instrument:** placing the instrument, with rack mount panels attached, into an equipment rack

Minimum Tool List

The following readily available tools are required for this installation process.

Table 2: Tools required for rackmount installation

Name	Description
Screwdriver handle (magnetic)	Accepts $\frac{1}{4}$ inch hex-head driver tips
No. 2 Phillips or Pozidriv tip	Phillips or Pozidriv-driver tip for number 2 size screw heads
T-15 Torx tip	Torx [®] -driver tip for T-15 size screw heads
$\frac{3}{8}$ inch wrench	Wrench or nutdriver can be used to install slides

These instructions are for personnel who are familiar with servicing the product. Further details for disassembling or reassembling the product can be found in the appropriate product manual. Contact your nearest Tektronix Service Center or Tektronix Factory Service for installation assistance.

Rackmount Panel Pre-Assembly

NOTE. Preassemble all sub-parts on the right and left-side panels before installing the rackmount panels on the instrument. Refer to Figure 3.

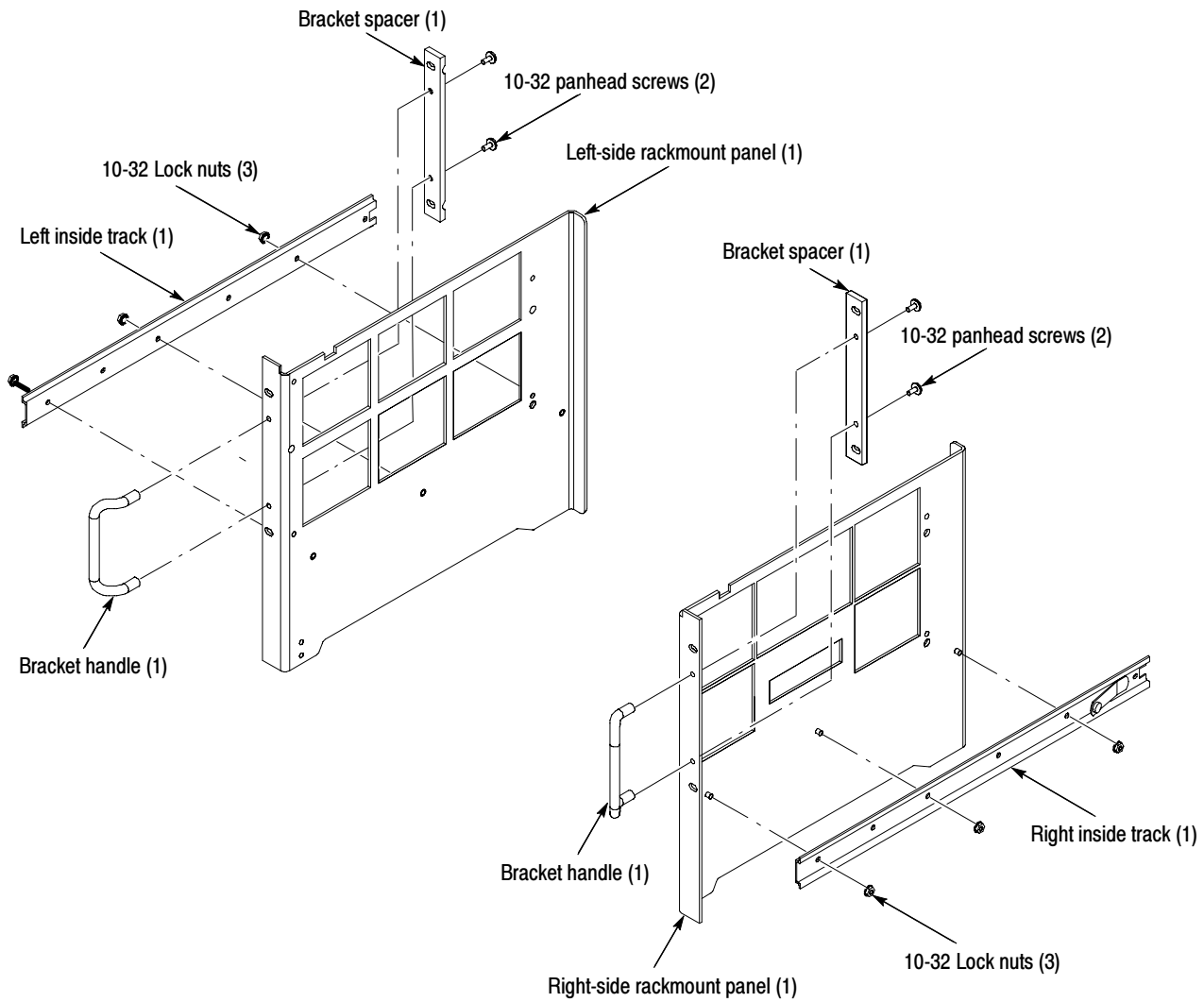

Figure 3: Rackmount panel preassembly

Instrument Conversion

This procedure shows you how to prepare the instrument for rackmount panel attachment and how to attach the rack mount panels. See Figure 4 and Figure 6 for a visual guide through this procedure.

Equipment Required Torxdriver with T-15 tip

Procedure

NOTE. *Retain all parts removed from the instrument in this procedure for later use. Some of those parts will be reinstalled as you perform this rack conversion. The remainder should be stored in case reconversion to a standard-instrument configuration is desired at a later time. Right-side or left-side references in these instructions assume you are viewing the instrument from the front panel.*

1. Remove the power cord.
2. Remove the four T-15 Torxdrive screws and snap studs that secure the top cover, and then remove the top cover by lifting the back up while pulling towards the rear.
3. Remove the left-side cover by sliding the cover towards the rear of the instrument.
4. Remove the two T-15 Torxdrive screws that secure the carrying handle to the right-side trim panel. Remove the handle and the trim panel.
5. Remove the five T-15 Torxdrive screws that secure the cabinet bottom to the instrument. Remove the bottom-cover trim from the instrument.

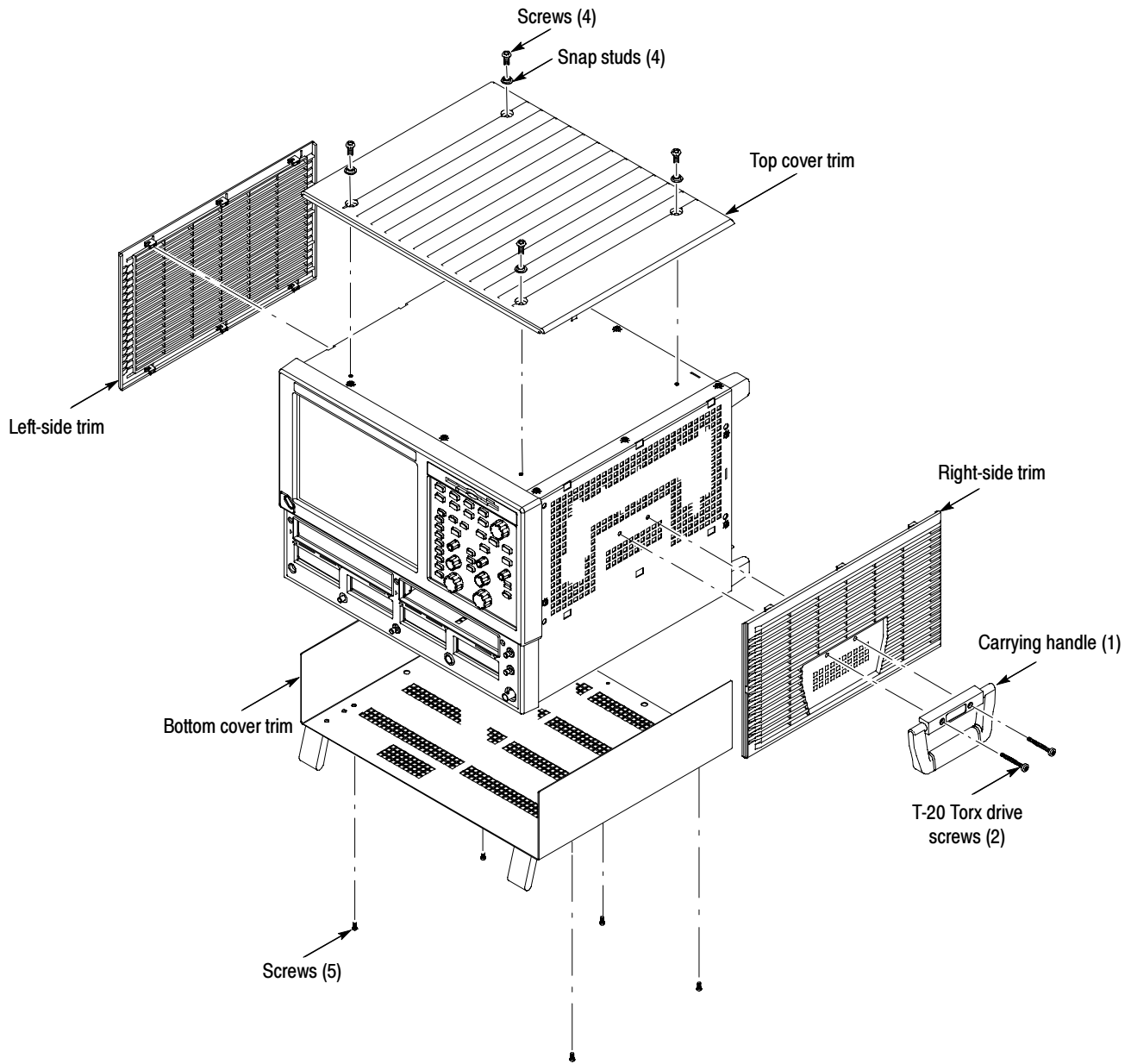

Figure 4: Removing instrument panels

6. Install the lower trim cover to the front of the rackmount panels using the four 10-32 Truss-head Phillips screws.
7. Reinstall the top cover by placing the front of the cover onto the instrument first, then lower the back into place. Secure using the four T-15 Torxdrive screws and snap studs.
8. Install the bracket handle and bracket spacer to the right-side rackmount panel. Secure by using the two 10-32 panhead, Phillips screws, applying 15 inch-lbs of torque. Refer to Figure 3, on page 6.
9. Install the right-side rackmount track over the three screw posts on the right-side rackmount panel. Use the six 8-32 locking-nut washer assemblies to secure the right-side rack track onto the rackmount panel, applying 28 inch-lbs of torque.



CAUTION. To allow the rackmount track to lock, make sure the track button latch is located towards the bottom of the rackmount panel. Refer to Figure 5.

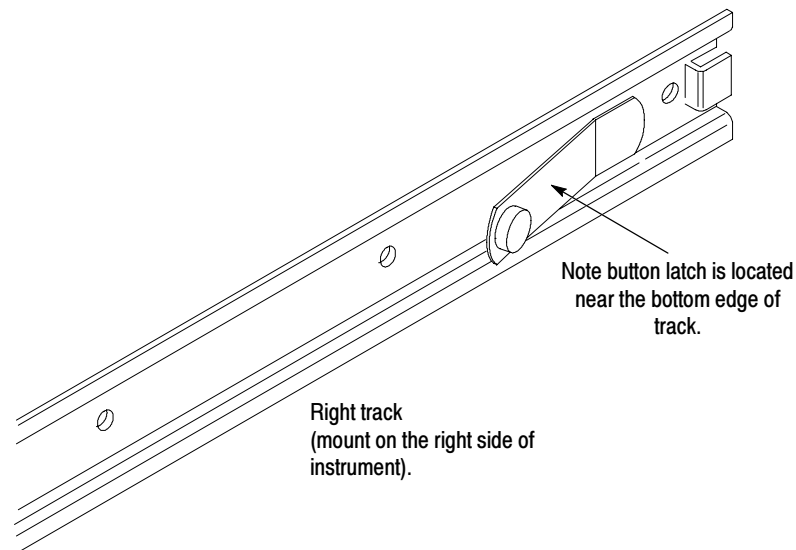

Figure 5: Right inside track identification

10. Install the right-side rackmount panel assembly to the right side of the instrument. Secure it by using the four 10-32 Truss-head Phillips screws, applying 28 inch-lbs of torque. Refer to Figure 6 on page 10.
11. Repeat steps 8 through 10 to install the left-side rackmount panel, substituting right-side for left-side.

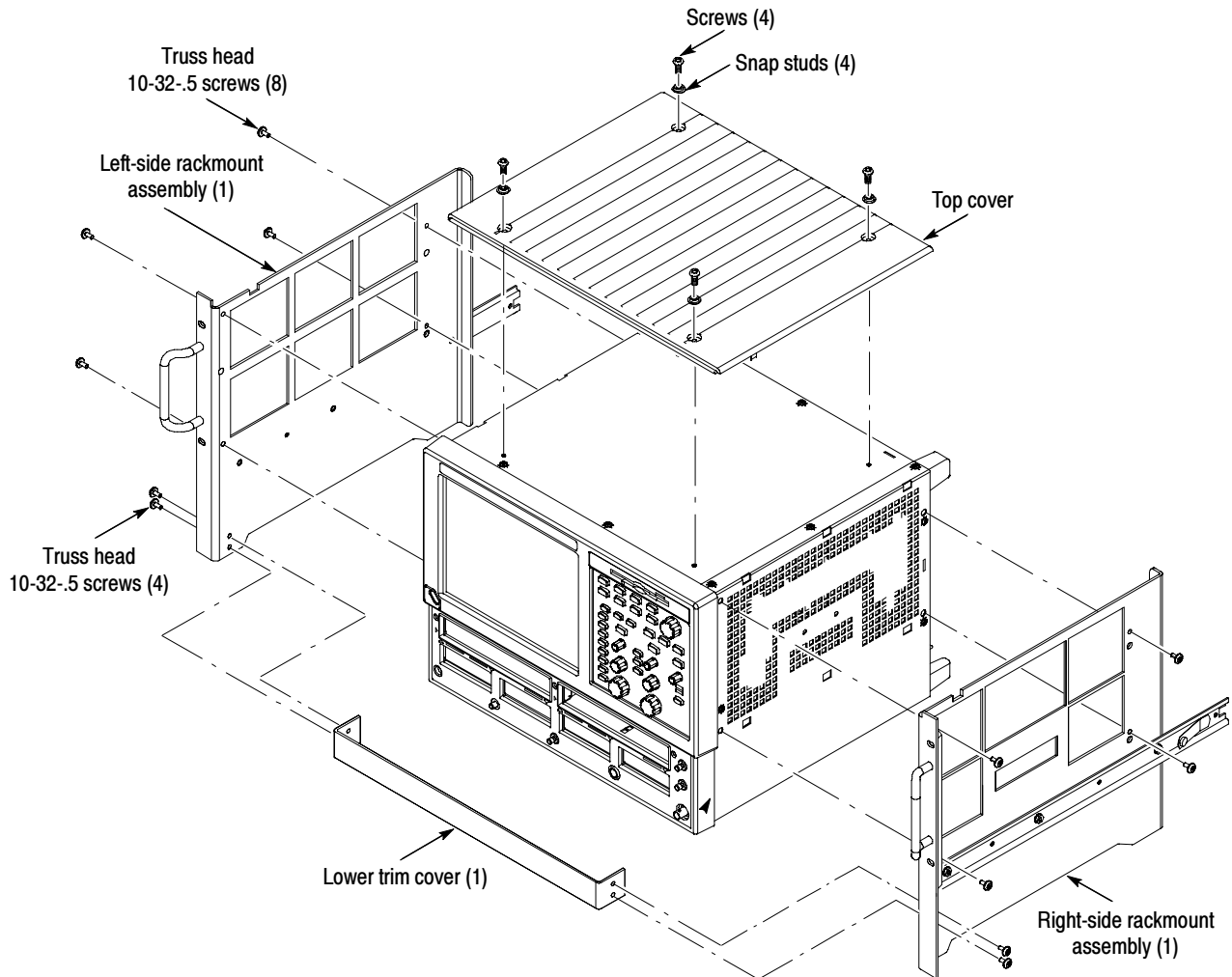

Figure 6: Installation of rackmount assemblies

Rackmounting the Instrument

This procedure helps you assemble and install the slide-out tracks in the equipment rack and then mount the rack-adapted instrument into an equipment rack.

The slide-out tracks allow the rack-adapted instrument to extend out of the rack for rear panel and connector maintenance without removing the instrument from the rack.



WARNING. *If slide-out track assemblies are disassembled for maintenance, do not interchange the left and right inner tracks when reinstalling them in the left and right outer tracks. If you do so, you will defeat the extension stop (safety latch) feature of the tracks. Equipment could, when extended, come out of the slides and fall from the rack, possibly causing personal injury and equipment damage.*



WARNING. *To prevent the rackmounted instrument from tipping forward onto the operator, install the instrument so that the operator will be able to access the rear panel without pushing down on the instrument.*

Verify that the rack does not become unstable with the instrument fully extended. Do not leave the instrument extended when finished accessing the rear panel.

NOTE. *The rack hardware kit contains hardware needed for mounting the instrument in several configurations. All of the hardware in the kit will not be needed.*

NOTE. *A standard equipment rack has rails with universal hole spacing. If you use a rack with other than universal hole spacing, you may have to drill additional mounting holes in the rack.*

Equipment Required

One screwdriver handle
One number two Pozidriv tip

Procedure

NOTE. *The included slide-out track assemblies (Figure 1 on page 2) come partially assembled to simplify their installation and to avoid accidental swapping of their inner tracks. (See WARNING on the previous page.) If tracks are not partially assembled, use Figure 7 on page 13 to match left and right slides. (Note that when the left and right tracks are oriented as shown, the round cutout is below the square cutout at the end of both inner tracks.)*

1. Assemble the slide-out track:
 - a. Identify the right versus left slide-out track assemblies: find the date code label on each assembly. The assembly to be mounted in the left side of the equipment rack (the side nearest the left side of the instrument when it is rackmounted) has a date code that ends with “LH,” for left hand. The right assembly has a date code ending with “RH.”
 - b. Measure the distance between the front and rear rail of the equipment rack.
 - c. Align the rear bracket to the right slide-out track as shown in Figure 7. Note the rear bracket has multiple pairs of mount-through holes. When aligning the bracket and track, be sure to select a pair of holes that mount the rear bracket so that the flange-to-flange distance (see figure) matches the front-rail to rear rail spacing of the rackmount rack just measured.
 - d. Using a screwdriver with a number two Pozidriv tip, secure the rear bracket to the right slide out track using two mounting screws and a bar nut as illustrated. Leave the screws loose so that the overall length of the slide-out track assembly can be adjusted when installing it in the rack.
 - e. Repeat substeps c and d to assemble the left slide-out track assembly.
2. Mount the slide-out track assemblies, using the slide drawer hardware listed in the kit parts list:
 - a. Select the mounting position in rack: Select two 0.5 inch spaced holes in the front rail. Verify that the 4.36 inch and 14 inch clearances exist relative to those mounting holes. See Figure 8, page 14.

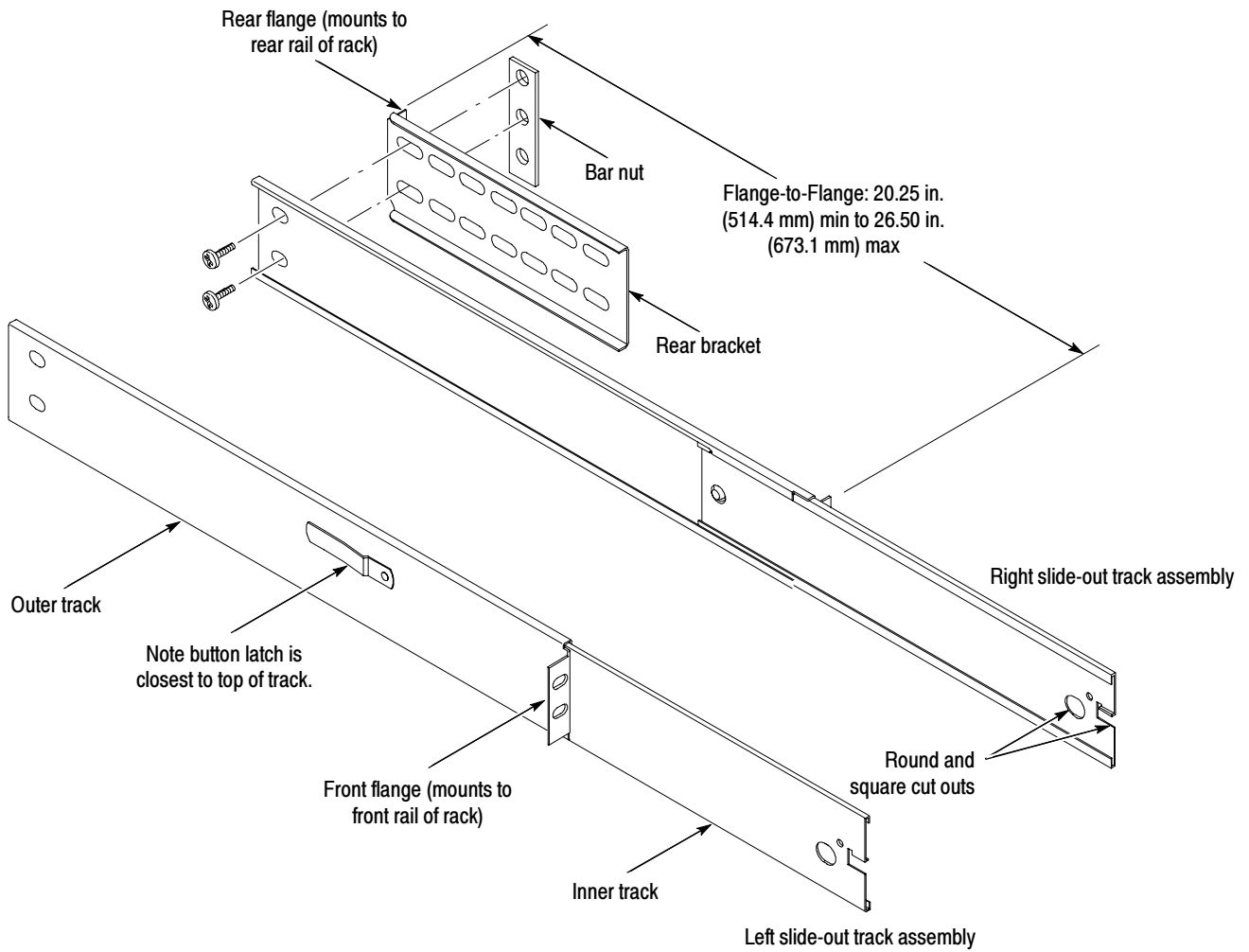

Figure 7: Assembly of slide-out tracks

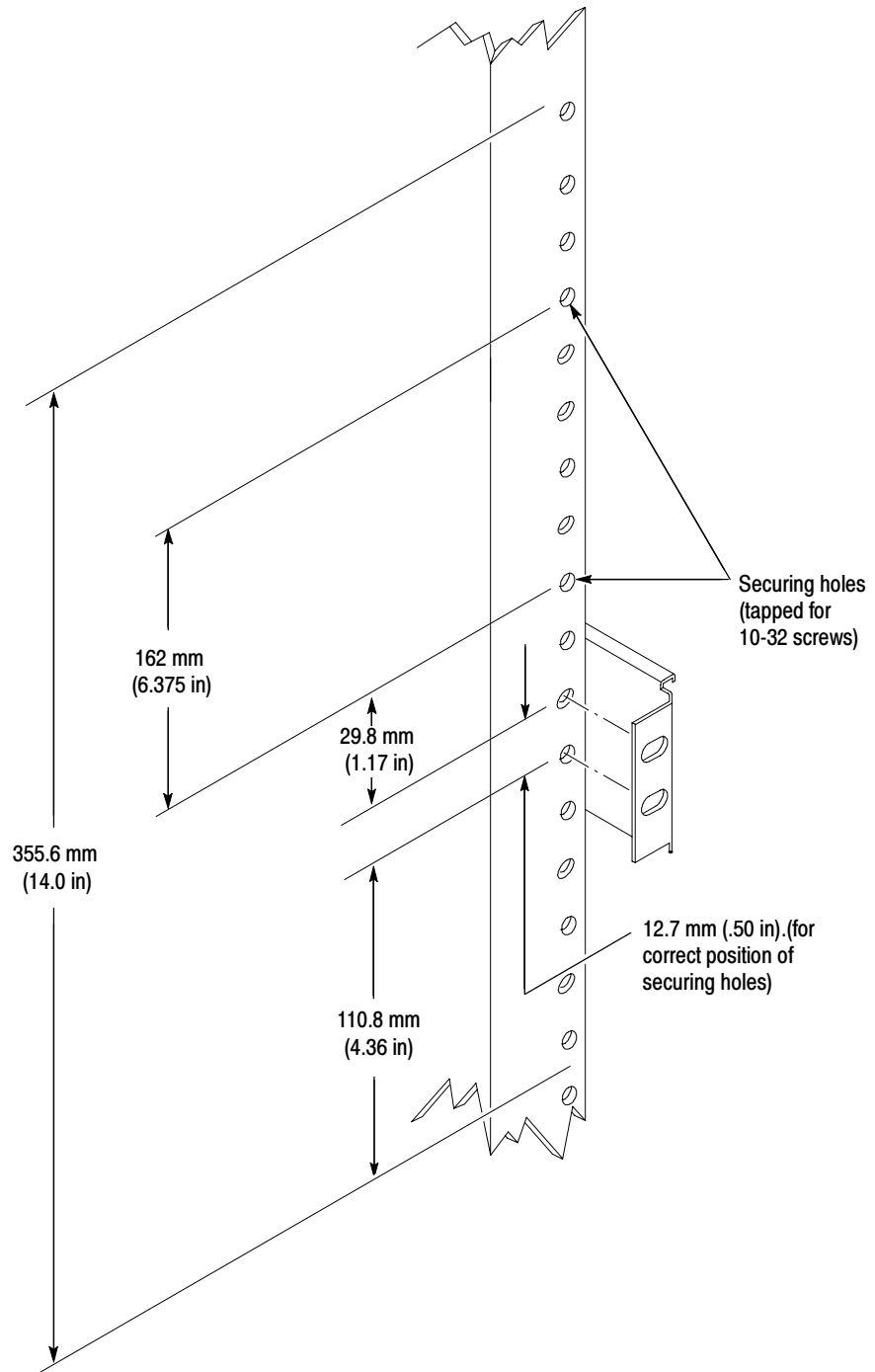

Figure 8: Vertical clearances for rack installation (left-front rail shown)

- b. Select mounting method according to rack type:
- To mount the slide-out tracks with their front and rear flanges outside of the front and rear rails, use method A, shown in Figure 9, when doing substep c. Add a bar nut to the installation only if the rails have untapped holes.
 - To mount with front and rear flanges inside of rails, use method B, shown in Figure 9. This mounting method assumes untapped holes.
- c. Install in rack: Using the method and hardware determined from substep b, secure the right slide-out track assembly to its front and rear rails. The screws should be fully, but lightly, seated so mounting can be adjusted later.
- d. Adjust the length of the slide-out track assembly by tightening the screws (left loose in substep d of step 1) by applying 28 inch-lbs of torque.
- e. Mount the left slide-out track assembly: Repeat substeps a through d to mount the left slide-out track assembly.

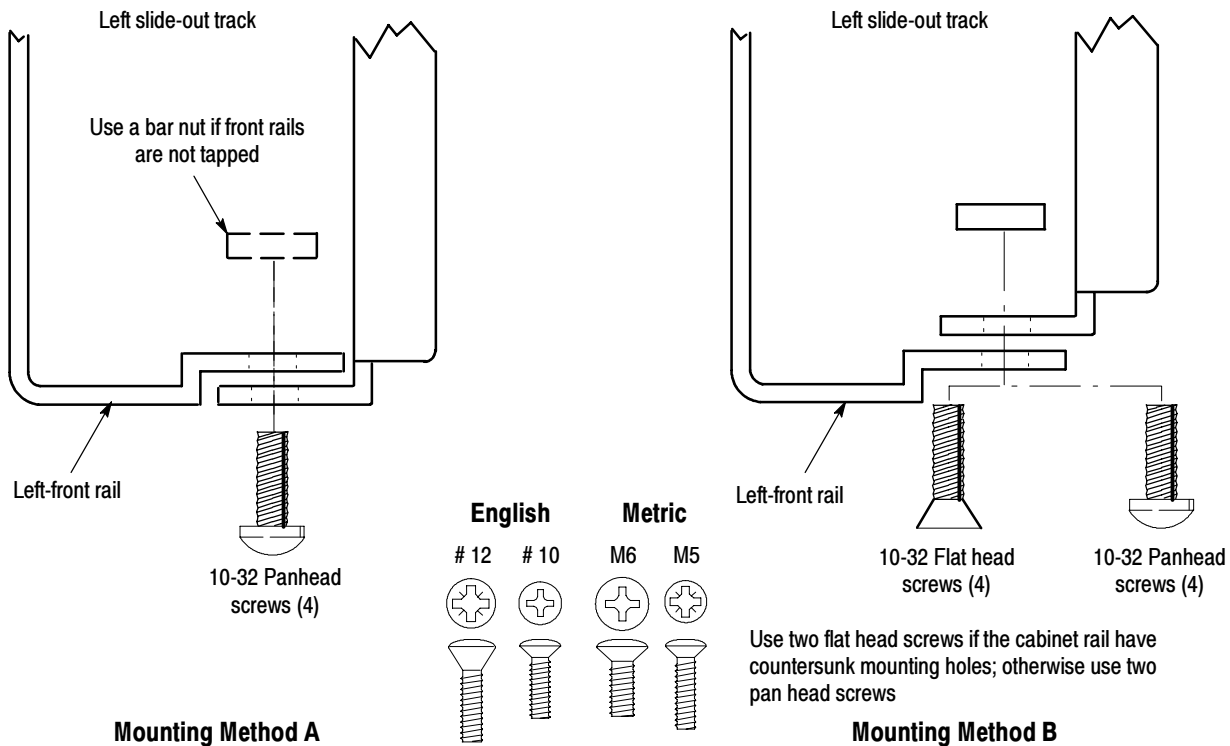

Figure 9: Installation of slide-out track assemblies in rack (top view)



WARNING. *To prevent the instrument from tipping or dropping onto the installers, two or more people should install this instrument into the rack cabinet.*

After completing the installation procedure, the installers should verify that the instrument and rack cabinet will not tip forward when the instrument is in the extended position.

3. Mount instrument in rack.

a. Install the instrument:

- Working from the front of the rack, slide the inner track of each slide-out track assembly until it extends out the front of the rack. Continue to slide them out until they lock.
- Insert the left and right tracks that extend from the rear of the instrument into the ends of the tracks just extended. Make sure the tracks mounted on the instrument slip inside the inner tracks extended earlier.
- Slide the rear of the instrument backwards until it stops.
- Push the button latches located on the outside of each track to unlock them and continue to slide the instrument all the way into the cabinet.

b. Level the rackmounted instrument:

- Tighten the four screws that were left loose at the rear of the rack when you did step 2, substep c, and then pull the instrument part way out of the rack.
- Be sure the four screws that were left loose at the front of the rack are loose enough to allow the slide-out track assemblies to seek their normal positions.
- Retighten the four screws and push the instrument all the way into the rack. If the tracks do not slide smoothly, readjust the level using the method just detailed.
- When leveling is completed, tighten the 10-32 screws using 28 inch-lbs of torque.

c. Secure the instrument and install the power cord:

- Locate and use one of the following types: 10-32 or 12-24 or M5-20 or M6-20 oval head screws. Insert each screw through its nylon finish washer as shown on the data sheet included with the hardware kit.
- Using a number two Phillips screwdriver, install the screw/washer assembly in one of the two mounting holes in the right front bracket. Repeat for the second mounting hole. Tighten both screws using 25 inch-lbs of torque.
- Install the two remaining screw/washer assemblies in the left front bracket using the method just described.
- Reinstall the power cord.

■ End of document ■