

Heat Sink Attachment Kits

020-2616-XX Chipcool 1 & 2 (mobile)

020-2617-XX Desktop

020-2618-XX Cooler Master

Installation Instructions

071-1629-00

NOTE. Follow the illustration steps from the bottom to the top.

020-2616-XX Heat Sink Attachment Kit (Chipcool 1 & 2) for TMSMPH1/2/3 probe head.



071162900

Kit Contents

- Attaching hardware kits
- Instruction sheet

Tools Required

- Phillips (P1) screwdriver to tighten the screws
- Flathead screw driver to lock the ZIF socket
- Optional: A torque wrench helps to ensure reliable connections by meeting the nominal torque values. When attaching screws use 2 in-lbs (0.226 N · m) of torque.

Overview

Use this instruction sheet for heat sink hardware installation. See the *TMSSY1 and TMSMD1 479-Pin Socket Hardware Support Manual* (071-1605-XX) to connect the probe head to the logic analyzer.

Only qualified personnel should perform these instruction procedures.

CAUTION. To prevent damage to the probe-head pins, carefully align your pin layout with the probe head pins before installing the probe head.

Procedure

You need to remove your heat sink and retention brackets before installing the probe head.

To install your heat sink hardware, follow the steps in the illustration that apply to your probe head and heat sink hardware.

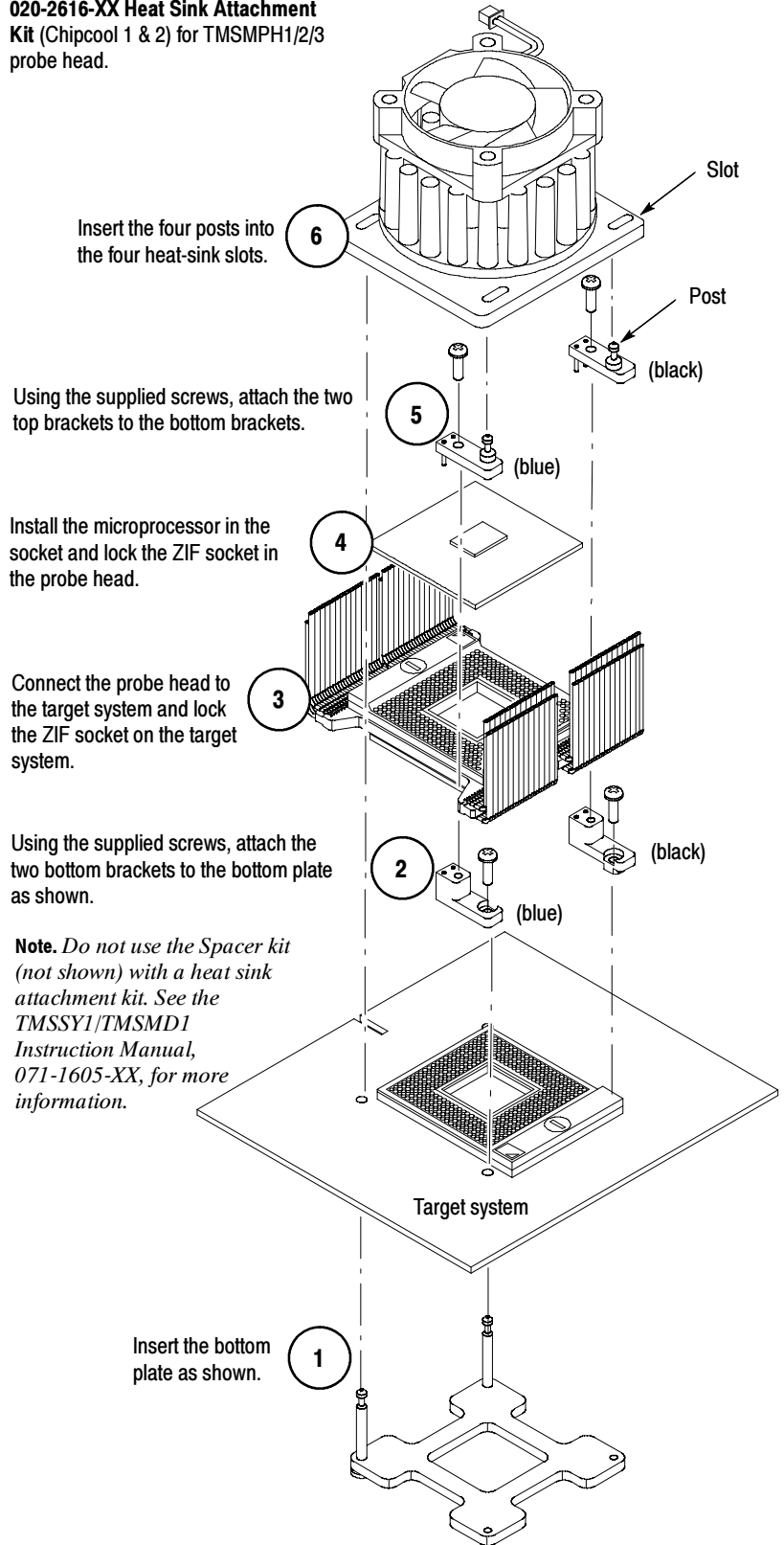

Table 1: 020-2616-XX Replaceable parts list

Description	Tektronix part number
ACCESSORY KIT; CHIPCOOL 1 & 2 HEATSINK, JEWEL CASE & HEAT SINK PARTS;TMSMPH1/2/3	020-2616-XX
4 SCREWS	211-3008-XX
2 TOP BRACKETS	407-5035-XX (BLACK) 407-5036-XX (BLUE)
2 BOTTOM BRACKETS	407-5037-XX (BLACK) 407-5038-XX (BLUE)
1 BOTTOM PLATE	386-7440-XX

Table 2: 020-2617-XX Replaceable parts list

Description	Tektronix part number
ACCESSORY KIT; DESKTOP HEATSINK ATTACH, JEWEL CASE & HEAT SINK PARTS; TMSMPH1, TMSMPH2/3	020-2617-XX
8 SCREWS, SOCKET CAP	212-0236-XX
4 STANDOFFS	129-1620-XX

Table 3: 020-2618-XX Replaceable parts list

Description	Tektronix part number
HEATSINK KIT; COOLER MASTER HEATSINK ATTACH, JEWEL CASE & HEAT SINK PARTS; TMSMPH3	020-2618-XX
2 STAND-OFF POSTS	355-0305-XX
4 SCREWS, PAN HEAD	211-0888-XX
2 UPPER BRACKET	407-5080-XX (GREEN) 407-5081-XX (RED)
2 LOWER BRACKET	407-5078-XX (GREEN) 407-5079-XX (RED)
1 COPPER SPACER	361-1825-XX

Contacting Tektronix

Phone 1-800-833-9200*

Address Tektronix, Inc.
Department or name (if known)
14200 SW Karl Braun Drive
P.O. Box 500
Beaverton, OR 97077
USA

Web site www.tektronix.com

Sales support 1-800-833-9200, select option 1*

Service support 1-800-833-9200, select option 2*

Technical support www.tektronix.com/support
1-800-833-9200, select option 3*
6:00 a.m. - 5:00 p.m. Pacific
Standard Time

* This phone number is toll free in North America. After office hours, please leave a voice mail message. Outside North America, contact a Tektronix sales office or distributor; see the Tektronix web site for a list of offices.

For Warranty information, see the Tektronix Website.

020-2617-XX Heat Sink Attachment Kit (Desktop) for TMSMPH2/3 probe heads.

Place the heat sink inside the brackets.

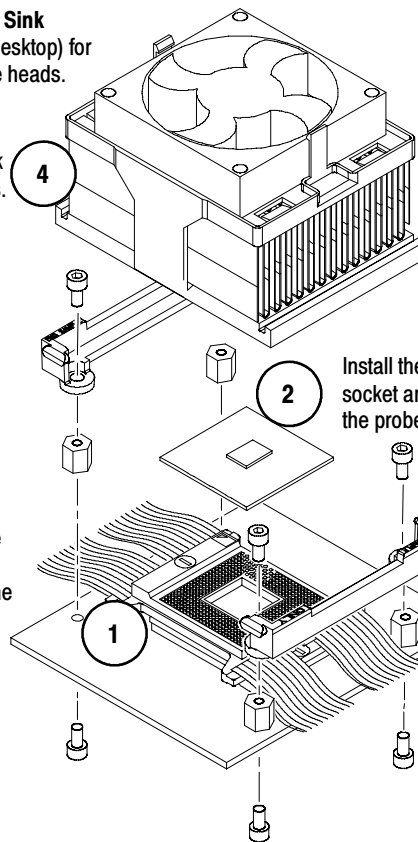

Connect the probe head to the target system and lock the target system ZIF socket.

Install the microprocessor in the socket and lock the ZIF socket in the probe head.

Using the supplied screws, attach the two brackets to the target system as shown.

020-2618-XX Heat Sink Attachment Kit (Cooler Master) for TMSMPH3 probe head.

Using the two supplied screws, attach the top brackets to the bottom brackets.

Install the microprocessor in the socket and lock the ZIF socket in the probe head.

Connect the probe head to the target system and lock the target system ZIF socket.

Using the two supplied screws, attach the two bottom brackets, then the two standoffs to the bottom plate as shown.

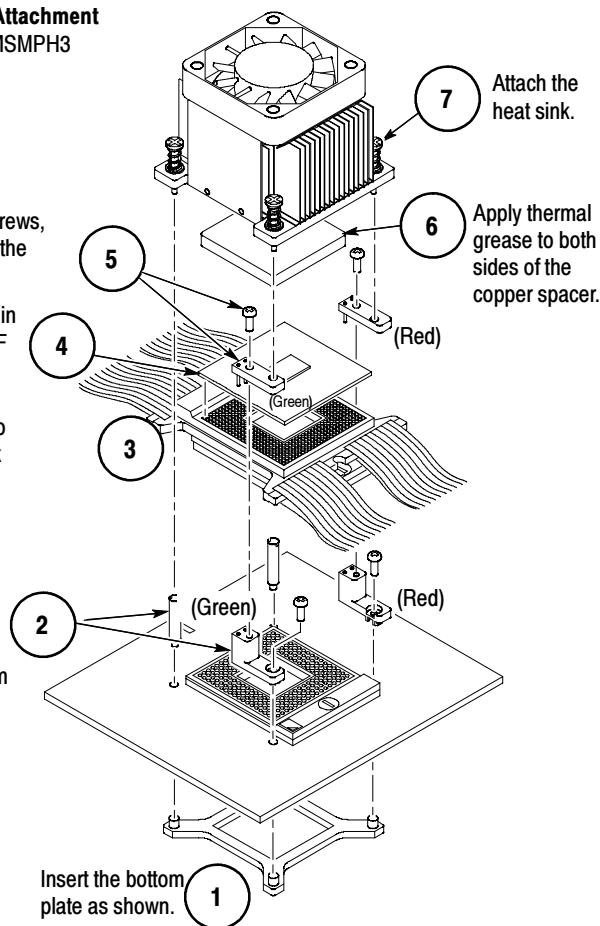

Insert the bottom plate as shown.

Attach the heat sink.

Apply thermal grease to both sides of the copper spacer.