

Introduction

WARNING The procedures contained in this packing list are intended for use by qualified service personnel only. Do not perform these procedures unless qualified to do so. Failure to recognize and observe normal safety precautions could result in personal injury or death.

This document provides installation instructions for the Keithley Model 4200-TMB. Read through this document and make sure all components required to complete the installation are available before proceeding.

NOTE The Model 4200 comes with a toolkit containing all tools required to properly install a Model 4200-TMB as described in this document—no special tools are required.

The Model 4200-TMB is intended to provide a secure mounting bracket for mounting the Model 4200-PA PreAmp on a probe station or test fixture triaxial connector plate. The Model 4200-TMB is designed to be compatible with the HP 04156-60002 connector plate or any other connector plate designed for use with HP 04155-61602 Kelvin Triaxial Cables. See Figure 1 for connector plate template.

Figure 1
Connector plate template

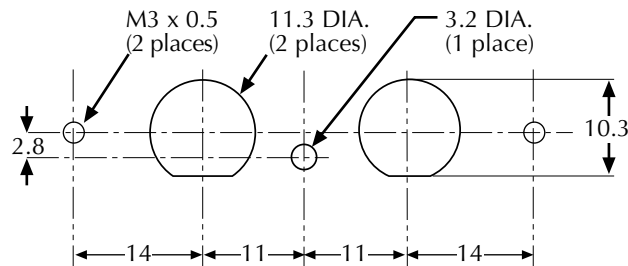

NOTE Dimensions are shown in millimeters (mm).

Installation

Use the following procedure for installing each 4200-TMB onto a probe station connector plate.

WARNING Turn off power from connected instrumentation and disconnect their line cords. Make sure all power is removed and stored energy in external circuitry is discharged. Failure to remove all power from the instrumentation could result in personal injury or death.

Step 1

Check if gender-changers are required. If so, install two gender-changers on the PreAmp's triax connectors.

Figure 2
Adapter assembly

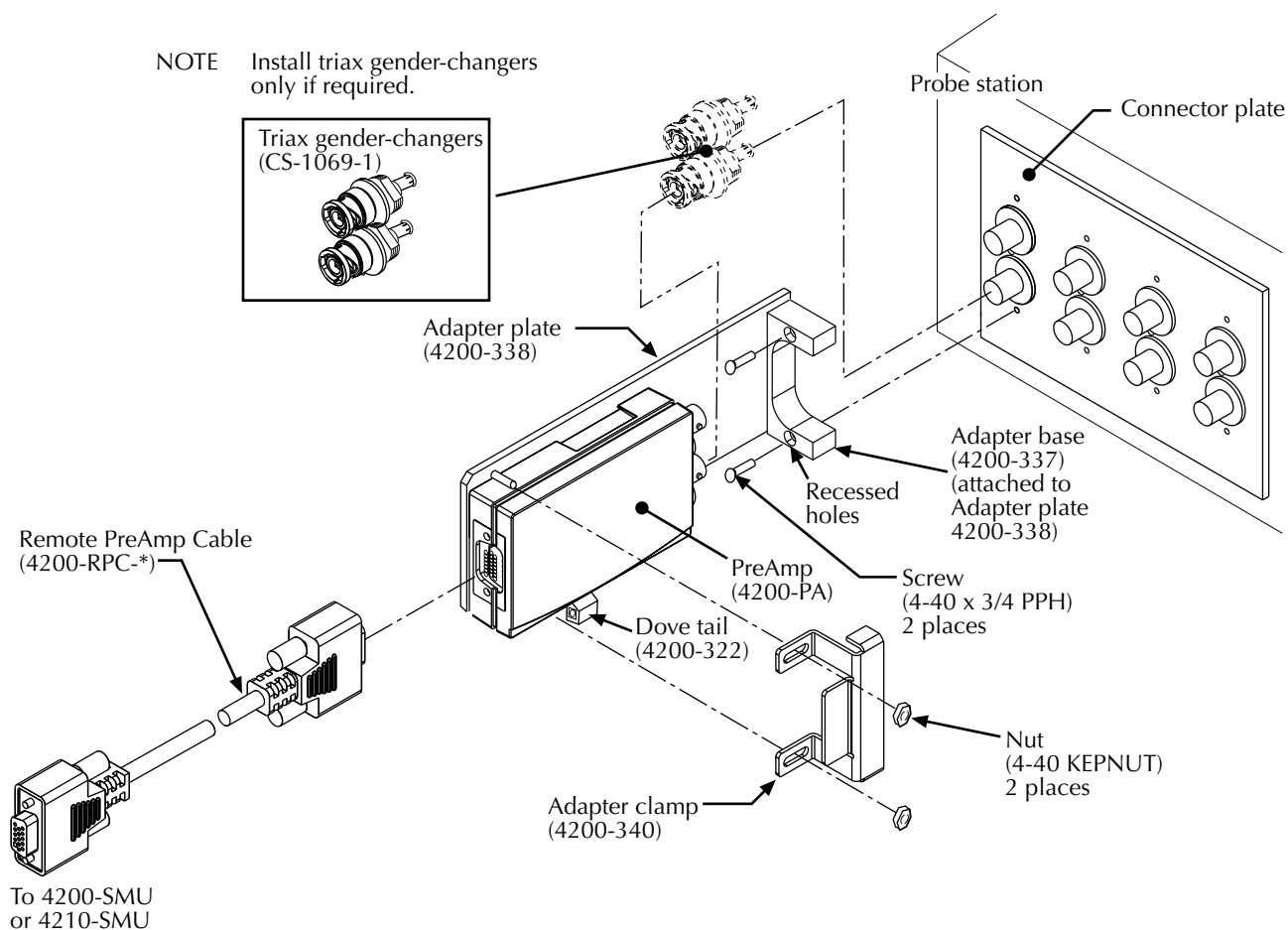

Step 2

Install Adapter base (4200-337) onto the connector plate around the desired triax connectors (Figure 2). Secure with provided screws (4-40-3/4 PPH).

Step 3

NOTE *If the Dove tail (Figure 2) is interfering with installation, remove it from the PreAmp by prying with a flat blade screwdriver. The Dovetail is not required when mounting the PreAmp in a bracket, only when mounting the PreAmp to a base.*

Place the PreAmp (4200-PA) on the Adapter plate (4200-338) and gently push the PreAmp onto the connector plate's triax connectors (Figure 2).

Step 4

Connect the 4200-RPC-* cable as shown in Figure 2.

Step 5

Secure the PreAmp (4200-PA) to the Adapter plate using the Adapter clamp (4200-340) and nuts (Figure 2). The completed installation is shown in Figure 3.

Step 6 (optional)

Attach PreAmp Ground lug to probe station ground using supplied Spade lug (Figure 3). See the 4200-SCS Reference Manual, Source Measure Concepts, for more details.

Figure 3
Installed adapter

