

**RSA6BUP Option WIN7
Windows 7 Upgrade for
RSA6120B Real-Time Signal Analyzers with Option WINXP
Instructions**

www.tektronix.com



071-3097-00

Tektronix

Copyright © Tektronix. All rights reserved. Licensed software products are owned by Tektronix or its subsidiaries or suppliers, and are protected by national copyright laws and international treaty provisions.

Tektronix products are covered by U.S. and foreign patents, issued and pending. Information in this publication supersedes that in all previously published material. Specifications and price change privileges reserved.

TEKTRONIX and TEK are registered trademarks of Tektronix, Inc.

Contacting Tektronix

Tektronix, Inc.
14150 SW Karl Braun Drive
P.O. Box 500
Beaverton, OR 97077
USA

For product information, sales, service, and technical support:

- In North America, call 1-800-833-9200.
- Worldwide, visit www.tektronix.com to find contacts in your area.

Table of Contents

- Kit Description..... 1
 - Products..... 1
 - Kit Parts List 1
- Installation Instructions 1
 - Installing the Windows 7 Removable Hard Drive 1
- Update the Instrument BIOS Configuration 2
 - Installing the Windows Certificate of Authenticity Label 4

Kit Description

This kit describes the installation of the RSA6BUP Option WIN7 Upgrade for RSA6120B instruments with Option WINXP.

Products

RSA6120B. All serial numbers, Option WINXP only

Kit Parts List

Quantity	Part number	Description
1 ea	NS ¹	SOFTWARE COA (CERTIFICATE OF AUTHENTICITY); MICROSOFT WINDOWS 7 PRO FOR EMBEDDED SYSTEMS 32/64BIT
1 ea	071-2179-03	MANUAL, TECH; SMPLP; TEKTRONIX SUPPLEMENTAL INFORMATION SHEET FOR THE PEOPLES REPUBLIC OF CHINA; CHINA ROHS
1 ea	071-3097-00	MANUAL, TECH; INSTALLATION, RSA6BUP WIN7, ONLY FOR RSA6120B UPGRADE
1 ea	650-5486-00	DISK DRIVE ASSY; PROGRAMMED, REMOVABLE HARD DRIVE, RSA6000B OPTION 56, WINDOWS 7

¹ NS — Not saleable

Installation Instructions

Upgrading to Windows 7 on an RSA6120B Option WINXP consists of replacing the Windows XP-based removable hard drive with a Windows 7-based removable hard drive and changing a BIOS setting to improve instrument performance under Windows 7.

Installing the Windows 7 Removable Hard Drive

To install the Windows 7-based removable hard drive:

1. From the Start menu, shut down the instrument.
2. After the instrument has shut down, loosen the two thumb screws that secure the removable hard drive. Pull the removable hard drive out of the instrument.

Place the removed drive assembly in anti-static packaging and store it in a protected location for possible future use or discard the drive, according to your organization's security protocols.

3. Install the new Windows 7-based removable hard drive into the instrument. Tighten the thumb screws to secure the removable hard drive.

Update the Instrument BIOS Configuration

To update the instrument BIOS:

1. With the instrument still shut down, connect a keyboard (either PS/2 or USB) to the instrument.
2. Turn on the instrument.
3. To enter the BIOS setup utility:

While the Tektronix screen is displayed, tap the DELETE key on the keyboard to enter BIOS setup.

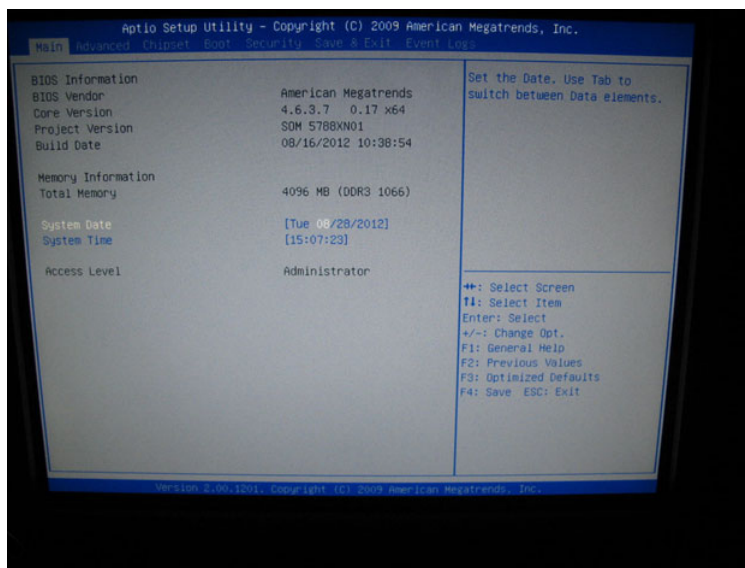

- Use the right arrow key to select the **Save & Exit** menu, then use the up/down arrow keys to select **Restore Defaults** and then press **Enter**.

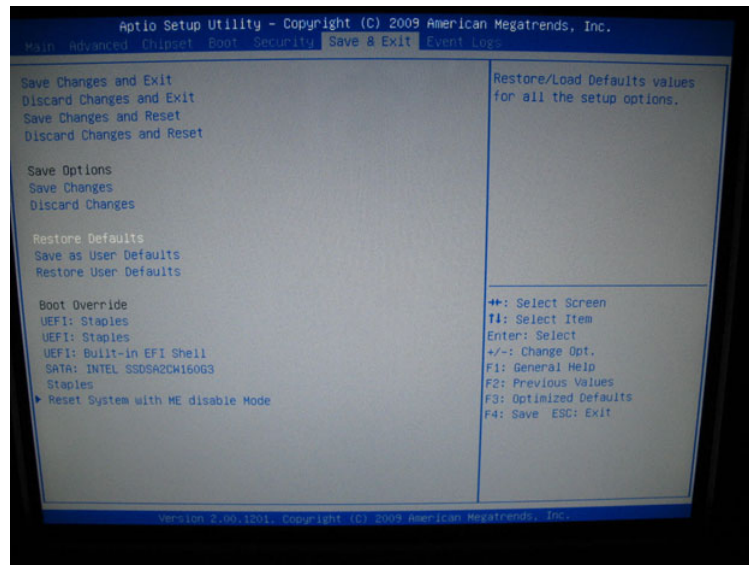

- Confirm Load Optimized Defaults by selecting **Yes**, then **Enter**.

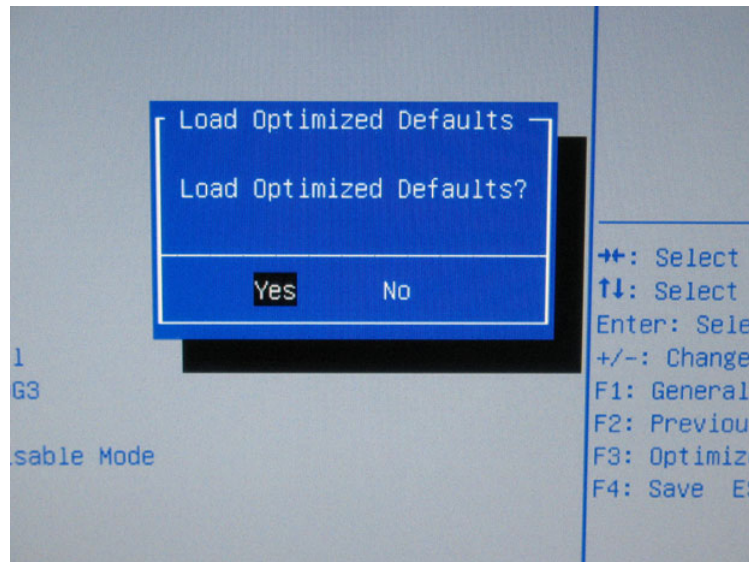

- Use up/down arrow keys to select **Save Changes and Exit**.

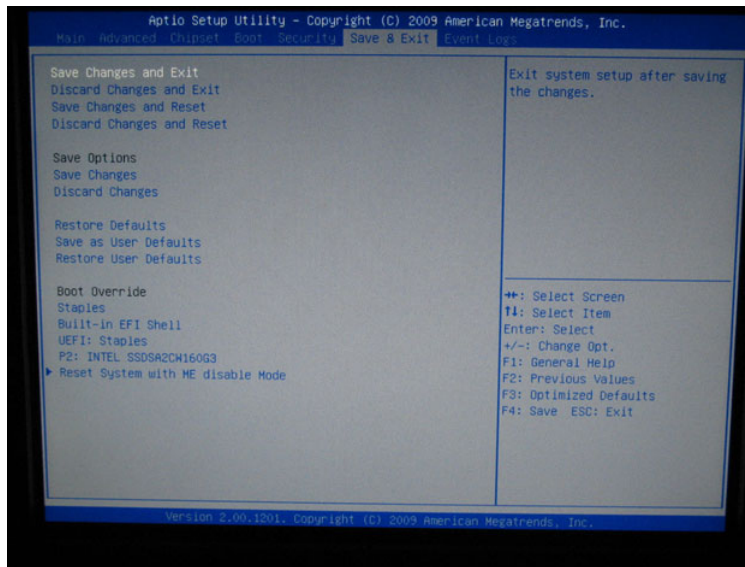

7. Use up/down arrow keys to select **Save Changes and Exit**.

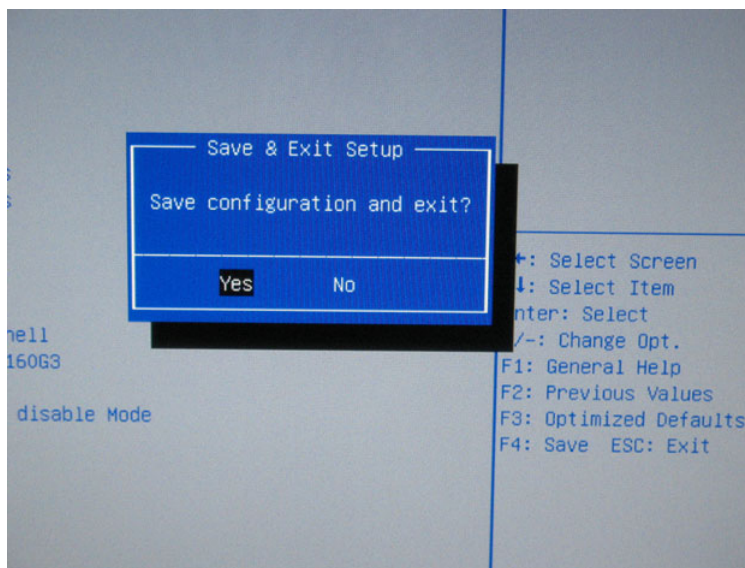

8. Confirm Save by selecting **Yes**, then **Enter**.

The system will now boot to Windows 7 and launch the RSA application.

Installing the Windows Certificate of Authenticity Label

Place the Windows 7 Certificate of Authenticity on the instrument rear panel.

This completes the installation of the RSA6BUP WIN7 upgrade kit.

■ End of Document ■